

7" RECESSED INTERCOM CUTSHEET

(see pages 2 and 3 for measurements)



TOUCHSCREEN

- Brightness : 1000 Nits
- Diagonal length: 7"
- Resolution: 1024 x 600
- Contrast ratio : 700:1
- Capacitive touch
- IP65 dust and water resistance
- Chemical resistant/ Anti-glare coated



COMPLETE SYSTEM

- Bluetooth connectivity
- Touch screen withstands a 225g drop ball test from 1.6 meters
- Designed for standard power socket: NEMA 5-15
- Min temperature: -30°C / -22°F
- Max temperature: +60° C/+140° F



DIMENSIONS

- 16.339" x 9.646" x 2.5"
- 415.0mm x 245.0mm x 63.5mm



POWER REQUIREMENTS

- Intercom input voltage: 24VDC
- Standard power consumption: 31W at 24VDC input
- Maximum power consumption: 65W at 24VDC input
- Relay max switching current: 5A, relay max switching power: 1250W
- No AC power directly connected to intercom
- Coordinate dedicated electrical circuit on UPS (power conditioned)



NETWORK REQUIREMENTS

- 2 Mbps ethernet connection - Cat5e/Cat6
- No WiFi
- No DSL
- IP assigned by DHCP by default - for static IP assignment call support
- 4G SIM card is supported (refer to building network requirements for details)



MISC.HARDWARE SPECIFICATIONS

- For camera angle adjustment, call support
- For the installation of the backbox, M4 countersink screws will be needed (not provided)

Support:

P: (800) 398-4416 ext. 2 (Mon - Fri 6 am - 10 pm EST)

E: support@butterflymx.com

7-F-v13-2022-11-30

© 2019 Runs Like Butter, Inc.

Page: 1 of 3

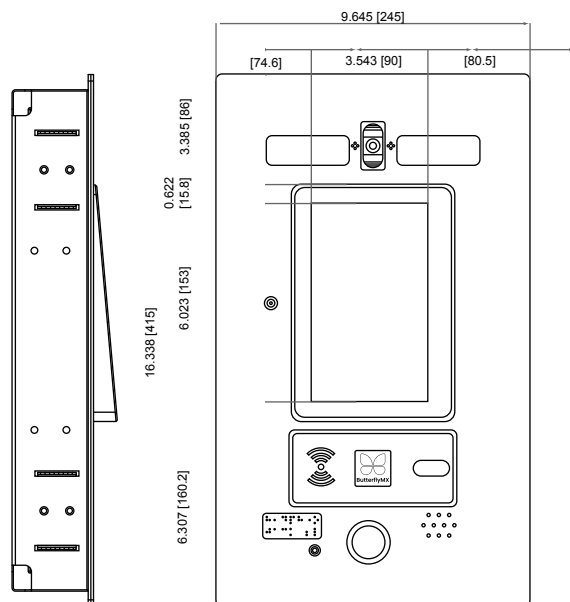

1 INTERCOM FRONT ELEVATION
NOT TO SCALE

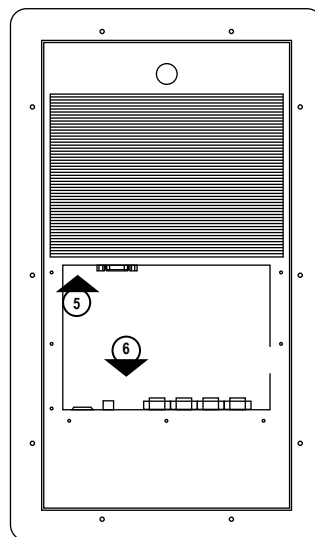

2 INTERCOM BACK ELEVATION
NOT TO SCALE

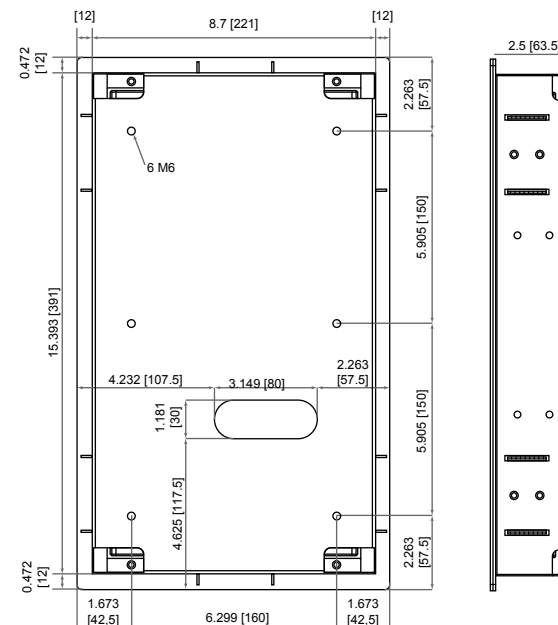

3 BACKBOX REAR AND SIDE ELEVATION
NOT TO SCALE

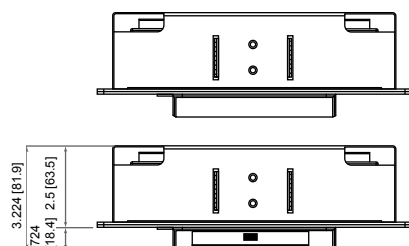

4 INTERCOM TOP/BOTTOM VIEWS
NOT TO SCALE

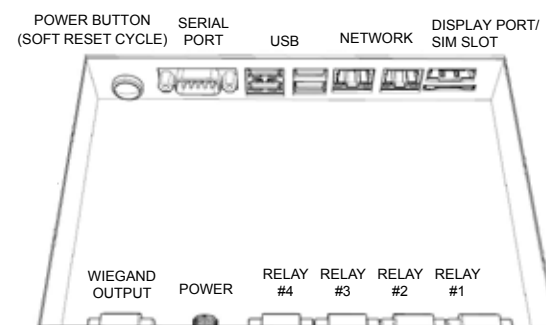

5 I/O PORT DETAIL
NOT TO SCALE

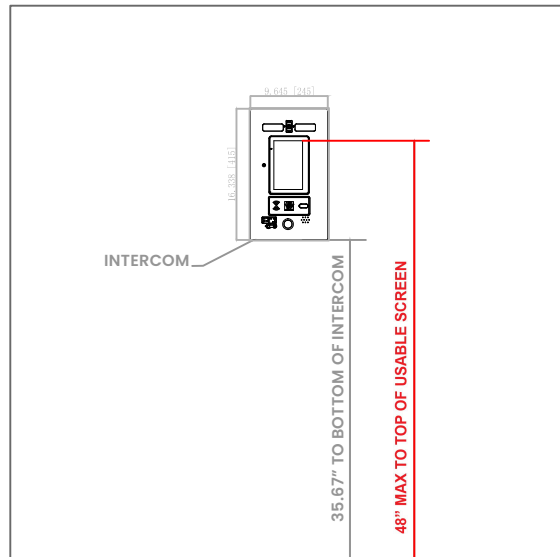

1 FRONT VIEW
NOT TO SCALE

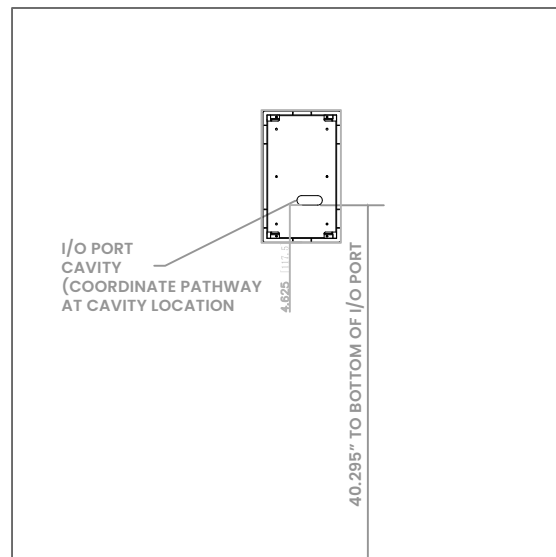

2 FRONT VIEW: BACKBOX PLACEMENT
NOT TO SCALE

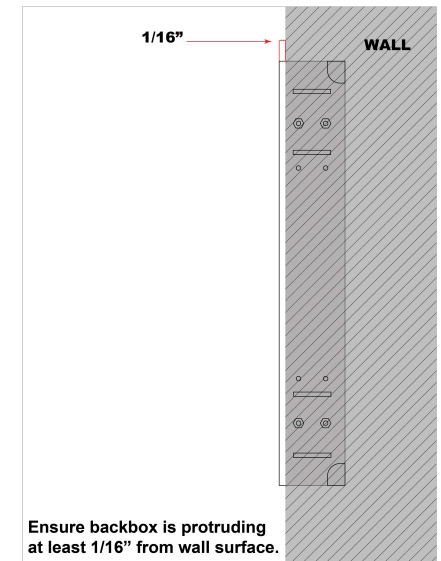

3 SIDE VIEW: BACKBOX IN WALL
NOT TO SCALE